

ERTORY THEATRE

gway Street
nganui

rawingroom architecture : design

FIRE EGRESS TO BREACH EXISTING PROPERTY BOUNDARY, RIGHT TO OCCUPY TBC BY COUNCIL

FUTURE PUBLIC STAIR BY WDC

BOUNDARY TO NEIGHBOURING COUNCIL SITE

NEW WALKWAY BY WDC

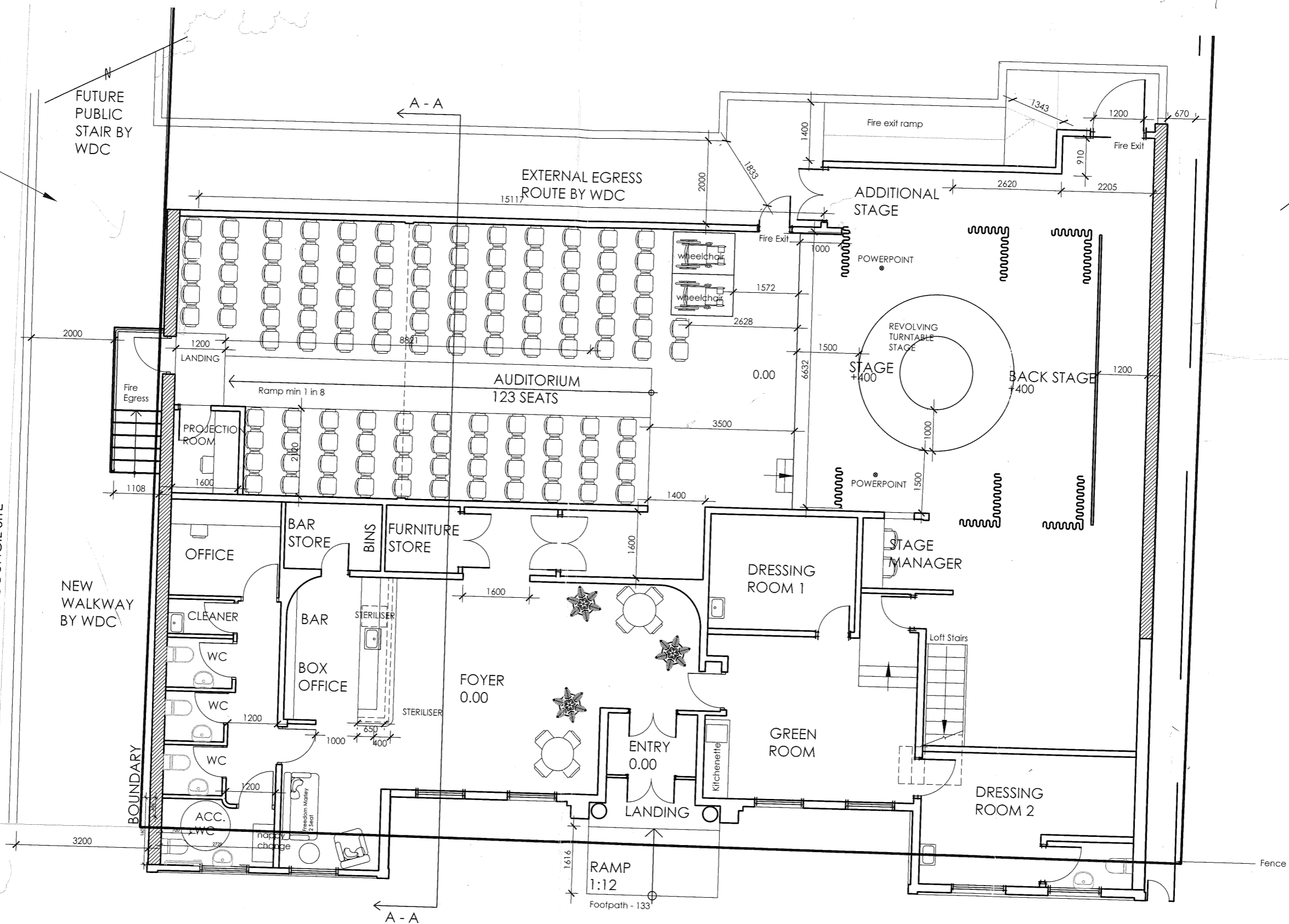

Proposed Plan

1:100 @ A3

D131 2.50

job:

dwg:

Elinor McDouall, Architect
studio@drawingroom.co.nz
mob. 021 468 425